

> MERCURY ST

DUCTED FAN COIL



Fully recirculated ventilation unit designed for operation with up to 10% outdoor air

Units Series

Unit type

MERCURY ST ducted fan coil

MERCURY ST E ducted fan coil with EC fans

Unit specification

- Horizontal or vertical installation
- Structure and panels made by Aluzink sheet metal thermal and acoustic insulated
- Synthetic filters G3
- Water heat exchanger to 3 or 4 ranks (optional 6 ranghi) with copper pipes and aluminum fins, fitted with internal drip tray in stainless steel
- Centrifugal fans directly coupled to electric motor (standard 3 speeds for MERCURY ST, brushless EC type MERCURY ST E)
- Electrical box on board

Accessories

- Oversized internal coil **6R** (only horizontal models)
- Intake grille - **GAS**
- Intake plenum - **PAS**
- Filtering section - **AF**
- Mixing section - **CM**
- Water post-heating section - **SRW**
- Electric post-heating section - **SRE I 2SRE**
- Sound proofed outlet plenum - **PAM**
- Outlet plenum for flexible ducts - **PBC**
- Outlet flange for connection to the ducts - **FM**
- Outlet with adjustable fins - **BRM**

Controller

For wall remote installation

- Speed controller - **COM3**
- Unit control panel - **PCU**
- Unit control panel with EC fans - **EC - PCUE**
- Unit control panel with SRE / 2SRE - **PC+PE**
- Unit control panel with 0-10V - **PC10R**

Technical data

MODEL	05	05 E	07	07 E	11	11 E	13	13 E	17	17 E	19	19 E	21	21 E	UM	
Nominal air flow rate	900		1500		1600		2100		2400		3600		4200		m ³ /h	
External static pressure / ESP ⁽¹⁾	95	95	100	100	85	80	110	125	105	110	120	90	115	100	Pa	
Sound static pressure ⁽¹⁾	50		51		52		55		55		58		58		dB (A)	
Electrical data	05	05 E	07	07 E	11	11 E	13	13 E	17	17 E	19	19 E	21	21 E	UM	
Power supply															230 / 1 / 50	V/ph/Hz
Max power input ⁽¹⁾	0.23	0.15	0.31	0.25	0.29	0.25	0.44	0.47	0.45	0.47	0.77	0.61	0.99	0.80	kW	
Max current input ⁽¹⁾	1.1	1.2	1.5	2.0	1.5	2.0	2.0	3.7	2.1	3.7	4.0	2.7	5.1	3.5	A	
Fans	05	05 E	07	07 E	11	11 E	13	13 E	17	17 E	19	19 E	21	21 E	UM	
Type motor	AC	EC	AC	EC	AC	EC	AC	EC	AC	EC	AC	EC	AC	EC	-	
N° speed ⁽²⁾	3	Multiple	3	Multiple	3	Multiple	3	Multiple	3	Multiple	3	Multiple	3	Multiple	-	
Control fans ⁽²⁾	Man	0-10V	Man	0-10V	Man	0-10V	Man	0-10V	Man	0-10V	Man	0-10V	Man	0-10V	-	
Standard coils	05	07	11	13	17	19	21	UM								
Total cooling capacity ⁽³⁾	4.6	7.5	9.1	10.5	13.1	15.7	20.7	kW								
Heating capacity ⁽⁴⁾	9.8	15.5	19.7	21.6	25.9	35.5	46.0	kW								
Water connections	G 3/4	G 3/4	G 3/4	G 3/4	G 3/4	G 1	G 1	"								
6 rows coils	05	07	11	13	17	19	21	UM								
Potenza frigorifera totale ⁽³⁾	6.2	10.7	11.2	14.3	17.5	24.1	26.8	kW								
Heating capacity ⁽⁴⁾	12.6	20.8	21.5	27.5	32.9	47.4	52.0	kW								
Water connections	G 3/4	G 3/4	G 3/4	G 3/4	G 3/4	G 1	G 1	"								
Post-heating coil. 2 rows	05	07	11	13	17	19	21	UM								
Heating capacity ⁽⁴⁾	6.8	10.9	11.5	13.5	16.0	20.3	22.2	kW								
Water connections	G 3/4	G 3/4	G 3/4	G 3/4	G 3/4	G 3/4	G 3/4	"								

(1): At top speed, with standard battery; Data referred to 1,5 m from inlet machine in free at nominal air flow-rate.

(2): Multiple = Multispeed > 3; Man = Manual from selector or keyboard; 0-10V = From potentiometer or keyboard.

(3) Inlet air temperature 27°C 47% UR, inlet/outlet water temperature 7/12°C

(4) Inlet air temperature 20°C, inlet/outlet water temperature 70/60°C

NOTE: Available on high-head version required.

DIMENSIONS

(drawing indicative of the series)

Horizontal models

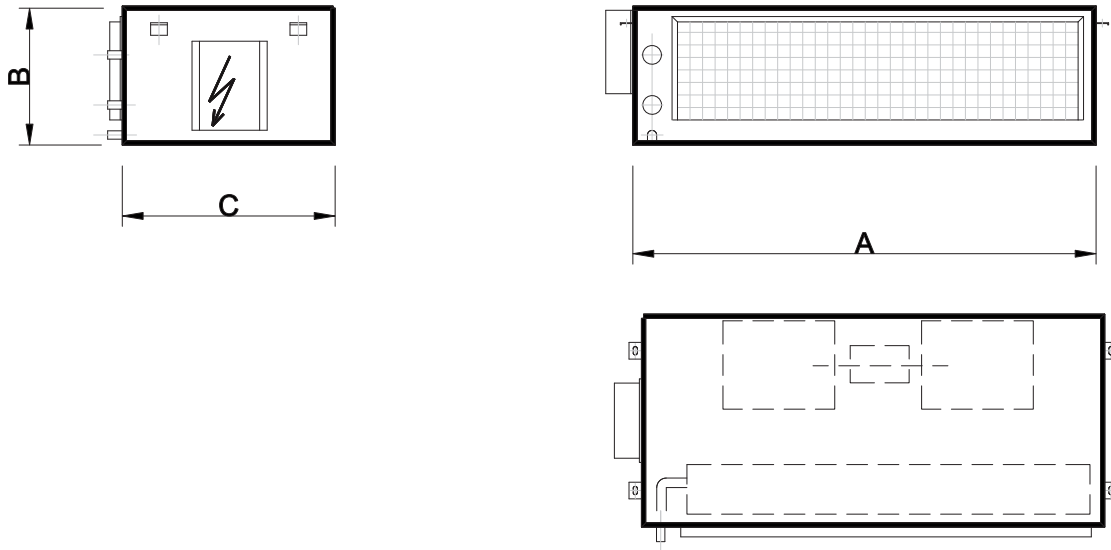

MODEL	05	07	11	13	17	19	21	UM
A	645	1000	1100	1100	1345	1345	1345	mm
B	296	296	325	325	325	375	375	mm
C	520	520	600	600	600	600	600	mm
Weight	24	34	37	41	47	55	60	kg

Vertical models

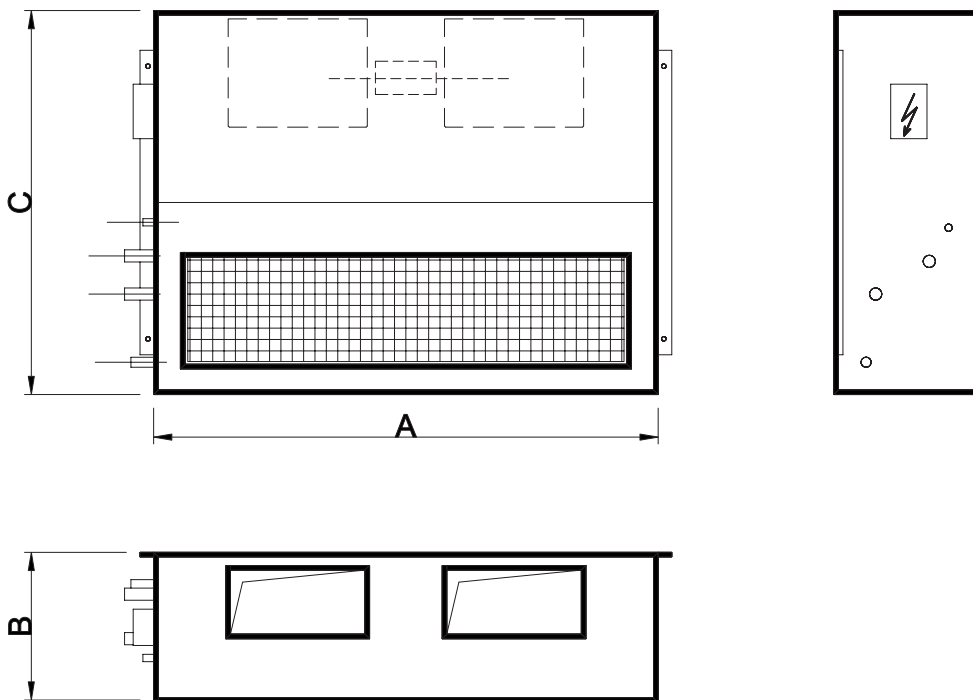

MODEL	05	07	11	13	17	19	21	UM
A	645	1000	1100	1100	1345	1345	1345	mm
B	296	296	325	325	325	375	375	mm
C	750	750	835	835	950	950	950	mm
Weight	30	45	48	54	63	72	75	kg